

# Ziptrak® Tensioning Tool

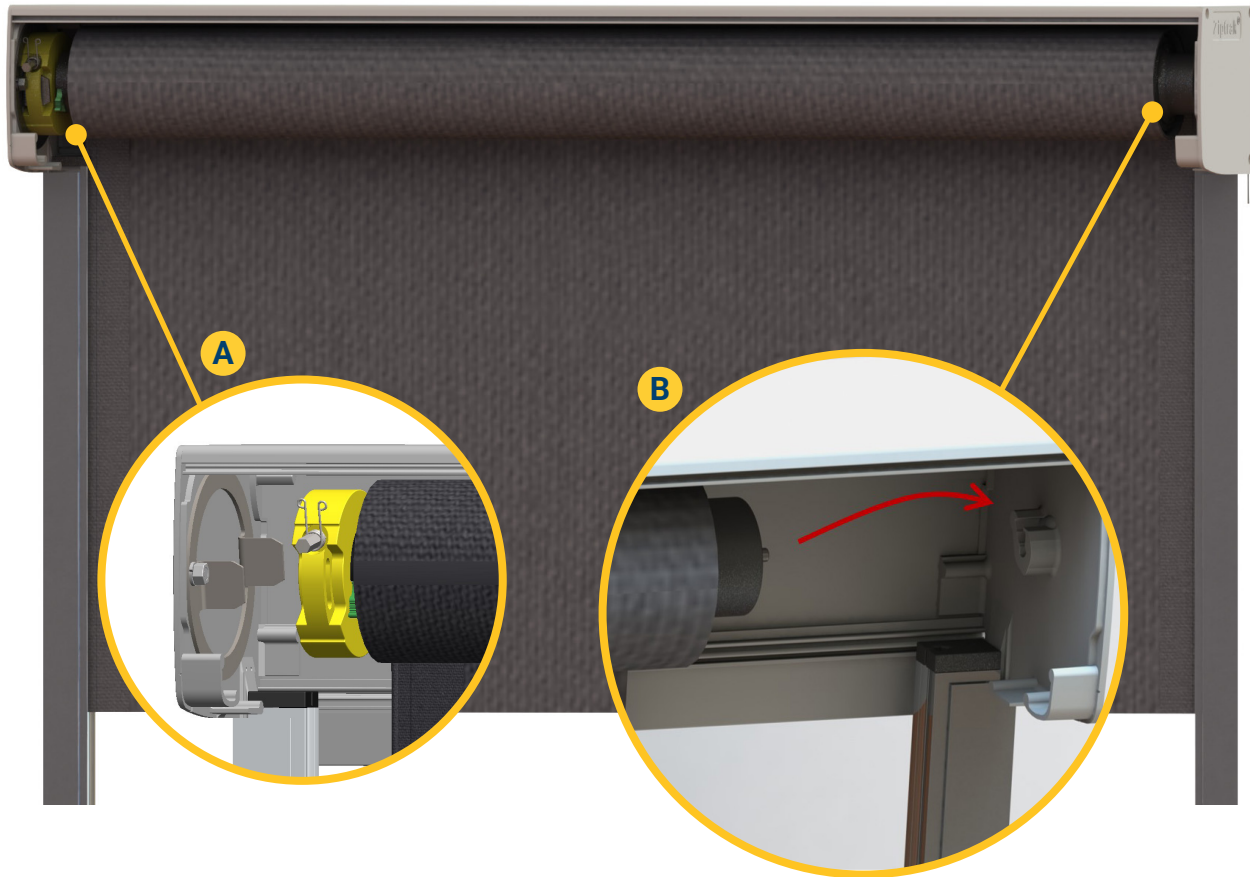

## Overview

The new Ziptrak® Tensioning Tool makes installing outdoor blinds with Streamline Pelmets easier, safer, and more efficient by allowing the installer to wind the spring with a drill. Best of all, it now comes standard with all Streamline Pelmets - at no extra cost!

## Pricing

No change to pricing! We're pleased to introduce this upgrade at no additional cost for the Streamline Pelmet. Should it be applied to the Traditional Pelmet or Cast Ends in future, pricing will be reviewed accordingly.

## Key product advantages

**Quick and easy adjustment** – faster setup with less effort  
**Less lifting required** – adjust tension without heavy handling  
**Accurate tensioning (A)** – easier tension adjustment with reduced handling  
**Improved safety** – reduces risk during installation  
**Front insertion option (B)** – The blind can now be inserted from the top on the idler side, enabling centre lifting and allowing a broader range of blinds to be installed by a single person.

## Compatibility

Initially available exclusively for blinds with the Streamline Pelmet. For product codes and deductions, refer to the 'What Fabricators needs to know' section.

## What Installers need to know

### Installation Tips:

1. A 7mm socket with extension is required to fit drill.



- 2A. Proper spring orientation is essential. Stickers marked "TOP" and "BOTTOM" indicate correct positioning.



- 2B. Tube insertion sequence changed - Insert from Tensioning Tool side first (left).

3. Remove the Hex Shaft Lock for tensioning, then **reinsert it afterwards**.  
Open to remove by widening the wings.

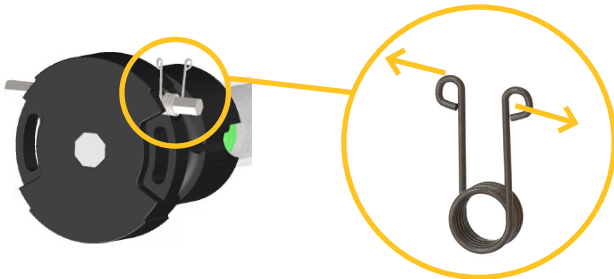

4. Set the drill to a low speed to avoid damaging the spring. Do **not** use an impact drill.
5. Stop tensioning once the bottom bar begins to lift slightly. **Caution:** Over-tensioning the spring may cause damage.

## Trade Hub

Please note the installation instructions, and the installation video are both available on the Trade Hub, Track Guided Installation Guide.



**File name:** Tensioning Tool Installation Instructions  
These replace Section 4.2 in the current Installation Manual and will be updated shortly to include the standard use of the Tensioning Tool in the Streamline Pelmet.

6. The helper spring must be **wound manually** – refer to the tables below for guidance.

### Helper Spring Turns Table

Helper SuperSpring and Keyway Tube for Sunscreen Mesh

	0-3.5	3.6-4	4.1-4.3	4.4-4.8	4.9-5	5.1-5.5	5.6-6
<2.4m		NO HELPER	12 / 20	14 / 22	12 / 20	21 / 29	22 / 30
2.4-3m	NO HELPER		13 / 22	15 / 24	13 / 22	MOTOR ONLY	
>3m		13 / 23	14 / 24	14 / 24	15 / 25		

### Helper SuperSpring and Keyway Tube for PVC

	0-3.1	3.2-3.5	3.6-3.8	3.9-4.3	4.4-5	5.1-5.5
<2.4m		NO HELPER	14 / 22	17 / 25	16 / 24	18 / 26
2.4-3m	NO HELPER		16 / 25	18 / 27	19 / 28	21 / 30
>3m		16 / 26	18 / 28	17 / 27	21 / 31	23 / 33

The **YELLOW** (left) numbers represent your required turns, if the skin is completely **ROLLED** (skin only at top)

The **WHITE** (right) numbers represent your required turns, if the skin is completely **UN-ROLLED** (skin completely down)

**Green** = Standard Spring with Helper Spring / **Black** = Extra Heavy-Duty with Helper Spring

7. To operate the lock, **simply squeeze the fabric**. This is only relevant when you are wanting to remove the blind with the tension on. Alternatively, remove tension using a drill in the anti-clockwise setting.



## What Retailers need to know

Please ensure this information is passed on to installers.

As the price, look, and functionality of the blinds remain unchanged, Ziptrak® Retailers will not be affected.

## Have a question about the Ziptrak® Tensioning Tool?

We recommend starting with our Trade Hub ([www.trade-hub.ziptrak.com](http://www.trade-hub.ziptrak.com)) – it's a great place to find the resources you need. If you'd prefer to talk it through, you can reach us at [enquiry@ziptrak.com.au](mailto:enquiry@ziptrak.com.au) or on 1300 77 00 65.

# What Fabricators need to know

Key updates in the new system:

1. No Changes to Deductions
2. Updated Springs
3. Updated End Plates

## 1. No Changes to Deductions

Please ensure the existing deductions for the top tube, skin, pelmet and other components remain unchanged.

## 2. Springs

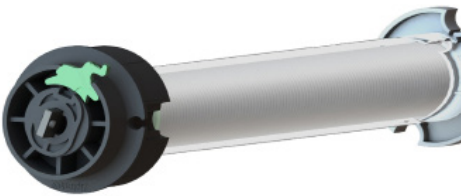
Current	NEW
	
<b>Zip 0700</b> SuperSpring without Idler - Standard	<b>Zip 0720</b> SuperSpring with Tensioning Tool w/ Idler - Standard
<b>Zip 0701</b> SuperSpring with Idler - Medium	<b>Zip 0721</b> SuperSpring with Tensioning Tool w/ Idler - Medium
<b>Zip 0702</b> SuperSpring with Idler - Short	<b>Zip 0722</b> SuperSpring with Tensioning Tool w/ Idler - Short
<b>Zip 0703</b> SuperSpring - Heavy Duty	<b>Zip 0723</b> SuperSpring with Tensioning Tool with Idler - Heavy Duty

Notes:

- a) No change needed for Helper Spring - Zip 0704.
- b) Current codes will continue to be supported by Ziptrak® for blinds with Case Ends and Traditional Pelmet.
- c) Box quantity will remain at 10 units, however the size of the cardboard box is increasing.

## 3. End Plates

End Plates will be available in the full range of Ziptrak® standard colours: Black, Cream, Mill Finish, Monument, Paperbark, Surfmist, White, and Woodland Grey.

Current	NEW
	
<b>Zip 061</b> 165 mm Streamline Pelmet End Plates	<b>Zip 061-03</b> 165 mm Streamline Pelmet End Plates for TT
<b>Zip 063</b> 135 mm Streamline Pelmet End Plates	<b>Zip 063-03</b> 135 mm Streamline Pelmet End Plates for TT

*\* Insure you add required colour when ordering end plates.*